

Side Brush Drive Hub Kit

Model: S5, S9, Scout 5, Scout 9 Sweeper



INSTALLATION INSTRUCTIONS:

Tool Required: 3mm Hex Tool

FOR SAFETY: Before servicing machine, park on level surface and turn off machine.

1. Remove battery and carefully tilt machine back to access drive hub.
2. Remove damaged hub.
3. Slide new hub on shaft until fully seated.
4. Torque set screw as specified.
5. Mount side brush to hub using wing screw assembly.
6. Carefully stand machine upright and reinstall battery.

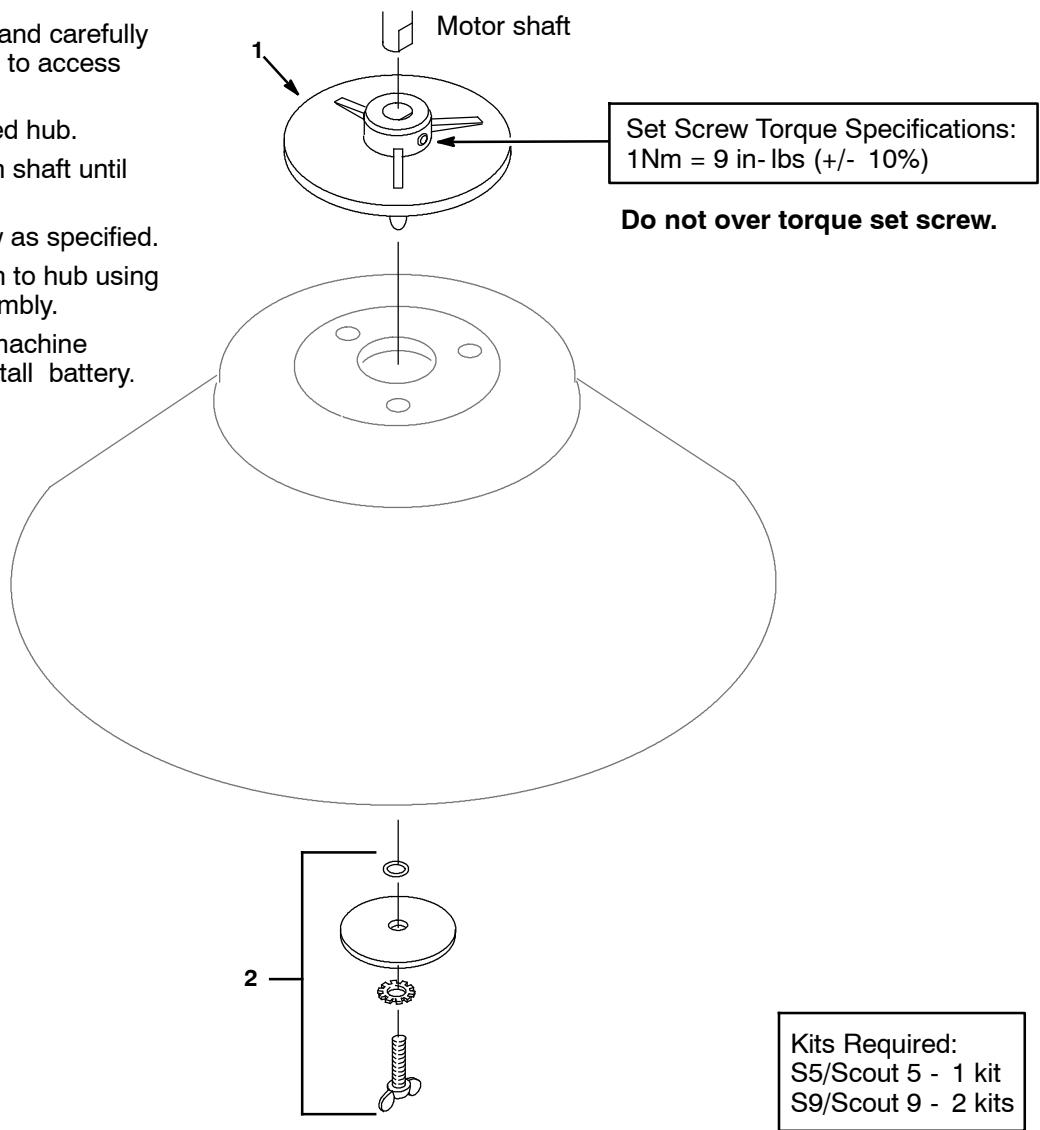

9013031 - Side Brush Drive Hub Kit Contents

Ref.	Description	Qty.
▽	Side Brush Drive Hub Kit	1
▲ 1	Side Brush Drive Hub w/ set screw	1
▲ 2	Side Brush Wing Screw Assembly (Includes wing screw, flat washer, external star washer and rubber retaining ring)	1

▽ = Kit ▲ = Included in kit